



**HORSEPOWER RATED**

# HEAVY CURRENT TIMING RELAY

SOLID STATE

ENCAPSULATED MODULE

30 AMPERE, SPDT, 2 HP RATED

**Series 847E – PERCENT**

CMOS DIGITAL CIRCUITRY



- Environment Protected
- Tamper Proof
- No False Operate
- Small Size – 2" x 3" x 1.35"
- Lightweight – approximately 2.5 oz.
- Rugged
- Transient Protected to 6000V

Output contact closes for an adjustable duration of ON time within each consecutive cycle of fixed time. Repeats continuously while energized.

Control the timing of high power electric heaters, HP rated motors, lamps, transformers and other heavy current loads rated less than 30 amps Resistive. CMOS digital circuitry is combined with high current output relay contacts. P/C board and internal components are encapsulated in a flame retardant molded housing, fitted with quick connect wiring terminals. Available in all standard voltages and frequencies. Fixed or adjustable timing from .1 seconds to 24 hours.

## TIMING DIAGRAM

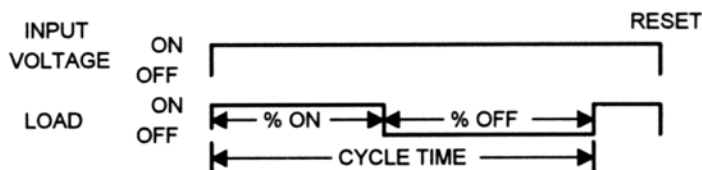

## SPECIFICATIONS

1. Repeat Accuracy:  $\pm 0.25\%$
2. Combined Effect of Temperature and Voltage upon Repeat Accuracy:  $\pm 2\%$  of Setting
3. Reset Time: 150 ms.
4. Operating Voltage Tolerance:  $\pm 20\%$
5. Load Current: 30 Amps General Purpose at 120/240VAC or 28VDC  
1HP@120VAC, 2HP@240VAC
6. Dielectric Strength: 1500 VRMS
7. Insulation Resistance: 100 Megohms Min.
8. Input Transient Protection: 3000V 120V UNITS, 6000V 240V UNITS
9. Temperature Ambients: Operating -40°C to +70°C Storage -55°C to +85°C
10. Humidity-Operating: 95% Relative
11. Contacts SPDT Standard, SPST/NO Optional

## HOW TO ORDER

**847E – (T) (V) (P)**

**847AE – (T) (V) (P)**

SERIES	(T) = CYCLE TIME	(V)=VOLTAGE	(P) = OPTIONS
<b>847E</b> (SPDT)  <b>847AE</b> (SPST/NO)	P - 5 SEC.	1 = 12VDC	O - CUSTOMER SUPPLIES OWN DUAL GANGED POTENTIOMETER E - DUAL GANGED POTENTIOMETER SUPPLIED
	1 - 10 SEC.	2 = 24VDC	
	L - 20 SEC.	3 = 48VDC	
	J - 30 SEC.	4 = 24VAC	
	M - 60 SEC.	5 = 120VAC	
	2 - 100 SEC.	6 = 240VAC	
	K - 120 SEC.	7 = 110VDC	
	F - 180 SEC.		
	E - 300 SEC.		
	3 - 1000 SEC.		
	4 - 10 MIN.		
	G - 30 MIN.		
	H - 60 MIN.		
	5 - 100 MIN.		
	V - 300 MIN.		
	6 - 1000 MIN.		
	D - 24 HRS.		

**MADE IN USA**

**EXAMPLE P/N: 847E-46** This is a PERCENT 30A Rated SPDT Timer with a 10 minute cycle time and an INPUT VOLTAGE of 240 VAC. The DUAL GANGED POTENTIOMETER is supplied.

American Control Products / Precision Timer  
a division of Prime Technology  
344 Twin Lakes Road  
North Branford, CT 06471  
Telephone: (203) 481-5721  
Fax: (203) 481-8937  
Email: sales@primetechnology.com  
www.primetechnology.com



## TECHNICAL BULLETIN

### SOLID STATE TIMING MODULE

PAGE 1  
OF 2

DATE  
3-11-02

**847E**

REV  
C

# ACCESSORIES – AVAILABLE FROM STOCK

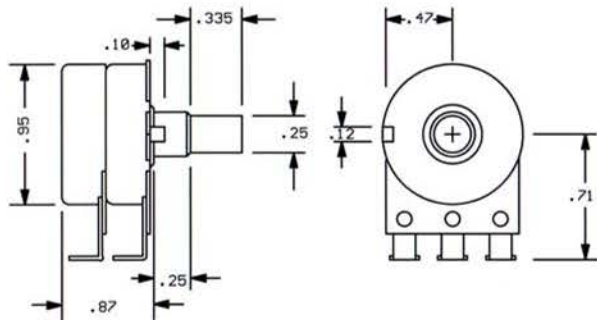

**DUAL POTENTIOMETER**  
Order P/N: DPM – 1M 1 Megohm  $\pm 20\%$

## TYPICAL WIRING

## OUTLINE DRAWING

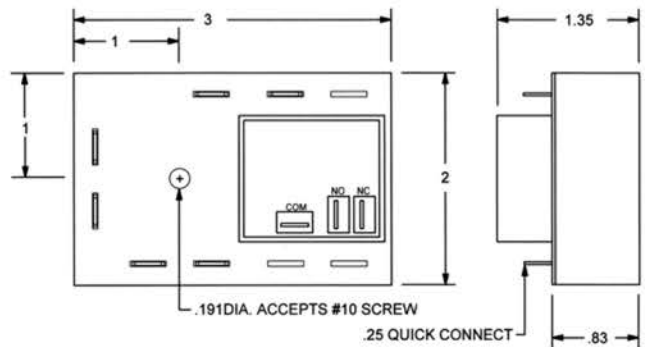
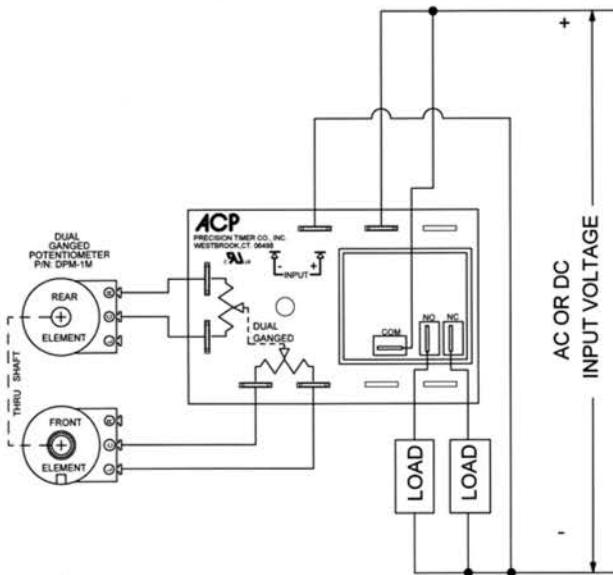

MADE IN USA



American Control Products / Precision Timer  
a division of Prime Technology  
344 Twin Lakes Road  
North Branford, CT 06471  
Telephone: (203) 481-5721  
Fax: (203) 481-8937  
Email: sales@primetechnology.com  
www.primetechnology.com

## TECHNICAL BULLETIN SOLID STATE TIMING MODULE

PAGE 2  
OF 2

DATE  
3-11-02

**847E**

REV  
C